

SELECT DESIRED TEXTURED
 POWDER COATED COLOR:

- | | |
|---|--|
| <input type="checkbox"/> BOSTWICK BROWN | <input type="checkbox"/> OIL RUB BRONZE |
| <input type="checkbox"/> CARDINAL BLACK | <input type="checkbox"/> NON-TEXTURED PEWTER |
| <input type="checkbox"/> CARDINAL GREY | <input type="checkbox"/> BENGAL SILVER |
| <input type="checkbox"/> COLD BROWN | <input type="checkbox"/> BLACK SUPER TEXTURE |
| <input type="checkbox"/> LAKESIDE SAND | |

SELECT DESIRED RECYCLED
 PLASTIC LUMBAR COLORS:

- | | |
|-------------------------------------|----------------------------------|
| <input type="checkbox"/> SAND | <input type="checkbox"/> REDWOOD |
| <input type="checkbox"/> SOFT GRAY | <input type="checkbox"/> WALNUT |
| <input type="checkbox"/> SLATE GRAY | |

SELECT DESIRED
 CUSTOMIZED SOLUTIONS:

- CUSTOM POWDER COATING (SETUP CHARGES MAY APPLY)
- BOTTLE AND CAN RECYCLER
- URBAN CIGARETTE RECEPTACLE
- INST-1 STAINLESS STEEL BOLT DOWN KIT

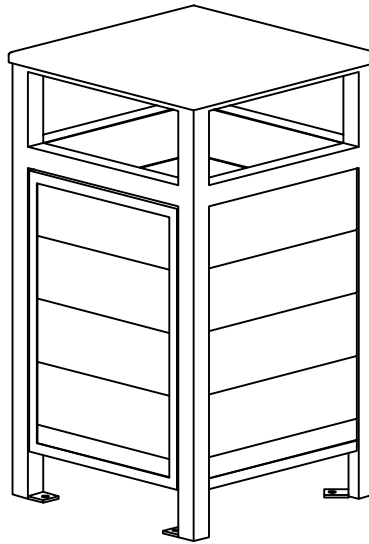

ISOMETRIC VIEW

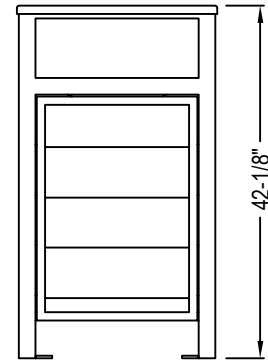

FRONT ELEVATION

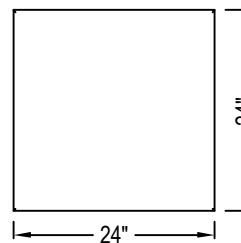

TOP VIEW

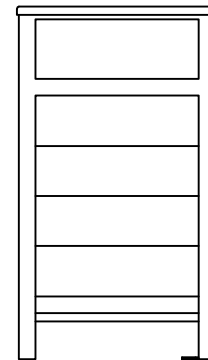

SIDE ELEVATION

SPECIFICATIONS:

- PERMA-DECK T&G RECYCLED PLASTIC SLATS
- DURABLE POWDER COATED ALUMINUM FRAME
- TOTAL HEIGHT:** 42" / 1067 MM
- WIDTH:** 24" / 610 MM
- DEPTH:** 24.5" / 622 MM
- WEIGHT:** 145 LBS / 66 KG
- CAPACITY:** 36 US GAL / 136 L
- RECYCLED CONTENT:** 50% RECYCLED CONTENT BY WEIGHT

NOTES:

1. INSTALLATION TO BE COMPLETED IN ACCORDANCE WITH MANUFACTURER'S SPECIFICATIONS.
2. DO NOT SCALE DRAWING.
3. THIS DRAWING IS INTENDED FOR USE BY ARCHITECTS, ENGINEERS, CONTRACTORS, CONSULTANTS AND DESIGN PROFESSIONALS FOR PLANNING PURPOSES ONLY. THIS DRAWING MAY NOT BE USED FOR CONSTRUCTION.
4. ALL INFORMATION CONTAINED HEREIN WAS CURRENT AT THE TIME OF DEVELOPMENT BUT MUST BE REVIEWED AND APPROVED BY THE PRODUCT MANUFACTURER TO BE CONSIDERED ACCURATE.
5. CONTRACTOR'S NOTE: FOR PRODUCT AND COMPANY INFORMATION VISIT www.CADdetails.com/info AND ENTER REFERENCE NUMBER 4289-079.

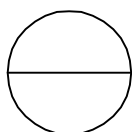

WASTE RECEPTACLES

URBAN FORM EASY ACCESS WASTE RECEPTACLE (UFEATR-30)