



WISHBONE SITE FURNISHINGS
 #109-27090 GLOUCESTER WAY
 LANGLEY, BC V4W 3Y5
 TOLL FREE: 1-866-626-0476
 PHONE: (604) 626-0476
 FAX: (604) 626-0496
 www.WishboneLtd.com

- SELECT DESIRED TEXTURED POWDER COATED COLOR:
- BOSTWICK BROWN OIL RUB BRONZE
 - CARDINAL BLACK NON-TEXTURED PEWTER
 - CARDINAL GREY BENGAL SILVER
 - COLD BROWN BLACK SUPER TEXTURE
 - LAKESIDE SAND

- SELECT DESIRED RECYCLED PLASTIC LUMBAR COLORS:
- SAND GREEN
 - GRAY BLACK
 - REDWOOD WALNUT

- SELECT DESIRED CUSTOMIZED SOLUTIONS:
- CUSTOM POWDER COATING (SETUP CHARGES MAY APPLY)
 - FLUSH MOUNT LOCKING DOOR LATCH
 - BOTTLE AND CAN RECYCLER
 - SIDE ASHTRAY
 - FOOT PEDALS ON ONE OR BOTH SIDES
 - DOUBLE FLAP DOORS
 - CUSTOMIZED LABELS
 - INST-1.5 STAINLESS STEEL BOLT DOWN KIT

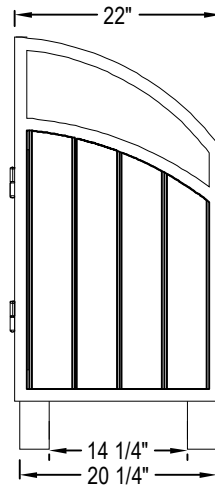

SIDE VIEW

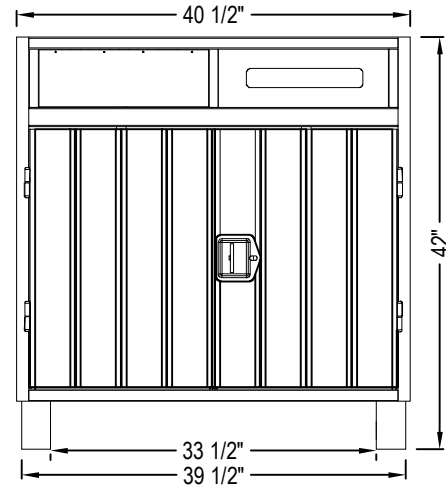

FRONT VIEW

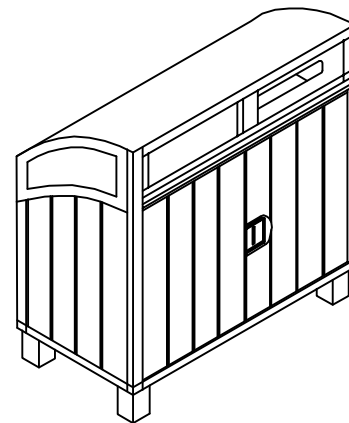

ISOMETRIC VIEW

SPECIFICATIONS:

- ULTRAPLAST™ RECYCLED PLASTIC SLATS
- DURABLE POWDER COATED ALUMINUM FRAME
- LONG LASTING STAINLESS STEEL HARDWARE
- HIDDEN FOOT LATCH FOR FRONT OPENING DOOR
- SURFACE MOUNT
- HEIGHT:** 42" / 1067 MM
- DEPTH:** 22" / 559 MM
- WIDTH:** 40.5" / 1029 MM
- CAPACITY:** 60 US GAL / 227 L
- WEIGHT:** 190 LBS / 86 KG
- RECYCLED CONTENT:** 90% RECYCLED CONTENT BY WEIGHT

NOTES:

1. INSTALLATION TO BE COMPLETED IN ACCORDANCE WITH MANUFACTURER'S SPECIFICATIONS.
2. DO NOT SCALE DRAWING.
3. THIS DRAWING IS INTENDED FOR USE BY ARCHITECTS, ENGINEERS, CONTRACTORS, CONSULTANTS AND DESIGN PROFESSIONALS FOR PLANNING PURPOSES ONLY. THIS DRAWING MAY NOT BE USED FOR CONSTRUCTION.
4. ALL INFORMATION CONTAINED HEREIN WAS CURRENT AT THE TIME OF DEVELOPMENT BUT MUST BE REVIEWED AND APPROVED BY THE PRODUCT MANUFACTURER TO BE CONSIDERED ACCURATE.
5. CONTRACTOR'S NOTE: FOR PRODUCT AND COMPANY INFORMATION VISIT www.CADdetails.com/info AND ENTER REFERENCE NUMBER 4289-039.

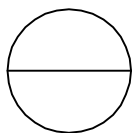

RECYCLING STATIONS

MODENA DOUBLE RECYCLING STATION (MCTRF - 39)